

21507330020

U. S. PUBLIC LAND SURVEY MONUMENT RECORD

SECTION 33 T 15 N, R 7 W, TOWN OF SHELBY

LA CROSSE COUNTY

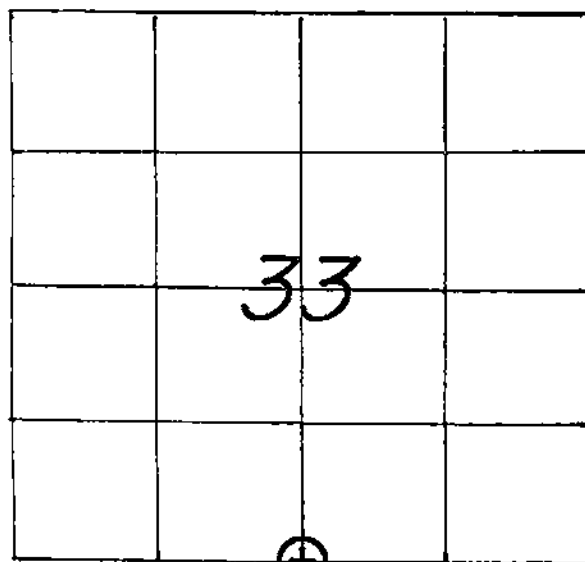

LOCATION OF LANDMARK

CREW: WILLIAM C. JUNG
 PETER F. FOLLANSBEE
 DATE: 12/11/2006

WISCONSIN COORDINATE SYSTEM

North

East

Theta Angle

Horiz. Order

Vert. Order

TYPE OF LANDMARK

3/4" x 30" IRON BAR WITH AN ALUMINUM CAP.

BEARINGS ARE REFERENCED TO

Describe any record evidence, monument evidence, testimonial evidence or any other material evidence you considered and whether the monument was found or restored through acceptance of an obliterated evidence location.

In November of 1932 a six man survey crew from the Corps of Engineers found an iron pipe at the corner. They also found the original bearing tree to the Northeast, the birch. The bearing and distance from the pipe to the tree fit the original call. We found the pipe with the top 8 inches rotted off. I drove an iron bar with a cap in the center of the old rusted pipe and pounded the monument down flush. I set a sign and post to the northeast.

Describe or show any material discrepancy between the location of the restored corner and that of the corner previously restored or reestablished.

NONE KNOWN.

RECORD OF DURABLE WITNESS MONUMENTS

| NO | DESCRIPTION | MAGNETIC | |
|----|--|----------|-----------|
| | | BEARING | DISTANCE |
| 1 | SET A NAIL IN N.E.-SIDE OF A 12" DOUBLE BURR OAK | N 69° W | 33.33 FT. |
| 2 | SET A NAIL IN N.E.-SIDE OF A 13" DOUBLE BURR OAK | N 39° W | 24.46 FT. |
| 3 | SET A NAIL IN S.E.-SIDE OF A 12½" BURR OAK | N 38° E | 10.44 FT. |
| 4 | SET A NAIL IN S.E.-SIDE OF A 15½" BURR OAK | S 15° W | 48.95 FT. |

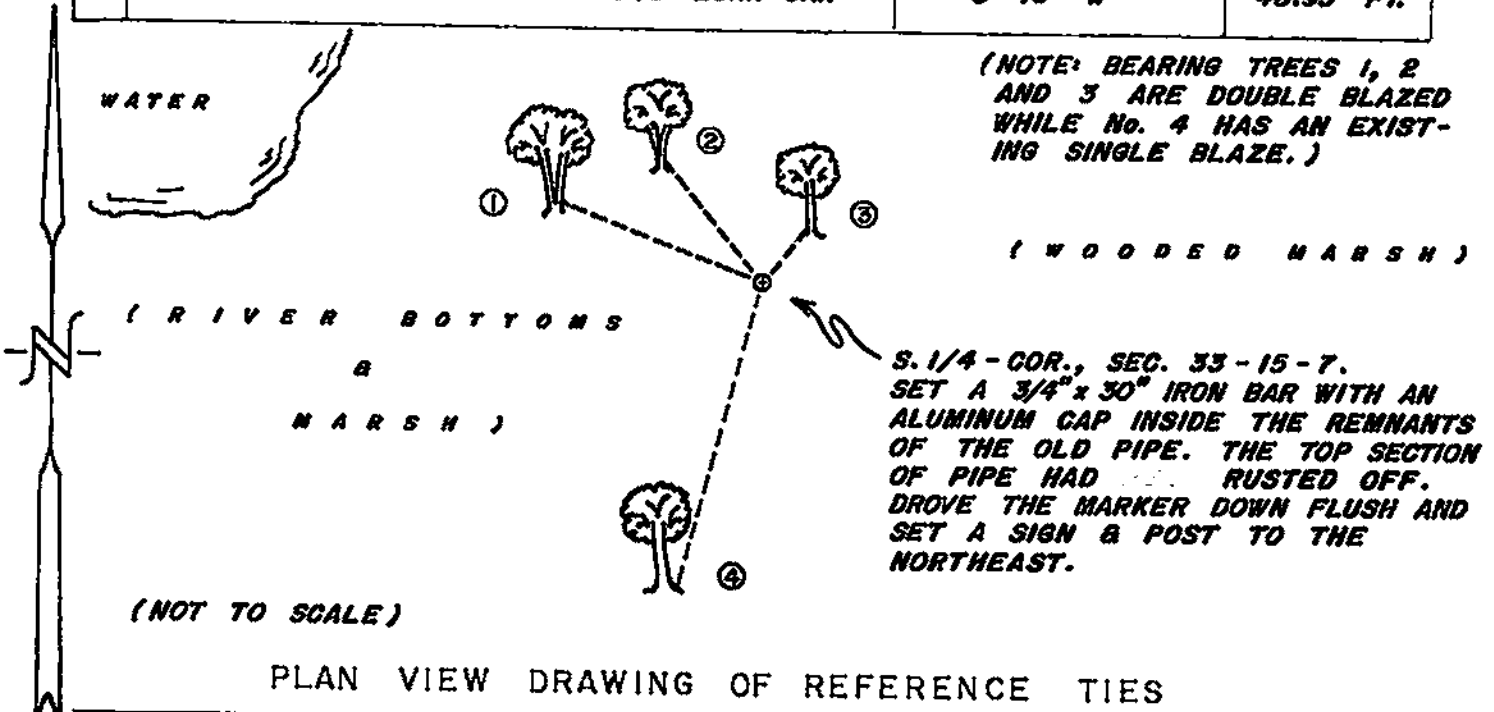

MAP SHOWING DISTANCE AND DIRECTION TO OTHER PUBLIC LAND SURVEY CORNERS USED FOR REESTABLISHING THE CORNER

No further section measurements were taken at this time.

I, WILLIAM C. JUNG, COUNTY SURVEYOR
 HEREBY CERTIFY THAT THE CORNER LOCATION SHOWN ON THIS RECORD
 WAS DETERMINED BY ME OR UNDER MY DIRECTION AND CONTROL AND
 THAT THIS U. S. PUBLIC LAND SURVEY MONUMENT RECORD IS CORRECT
 AND COMPLETE TO THE BEST OF MY KNOWLEDGE AND BELIEF.

William C. Jung 1/17/07
 Signature Date

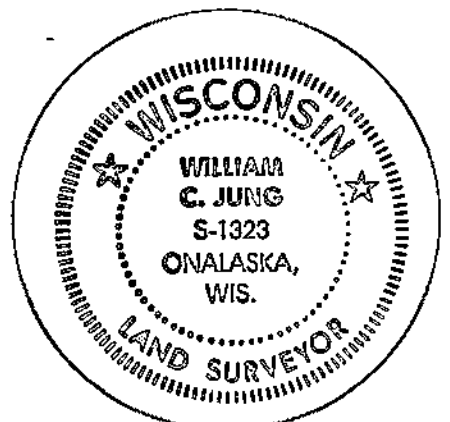

Seal