

**VERNON COUNTY COORDINATE SUBMISSION FORM**  
**"As An Addendum To"**  
**VERNON COUNTY**  
**CERTIFIED U.S. PUBLIC LAND SURVEY MONUMENT RECORD**

INSTRUCTIONS: THIS RECORD FORM SHOULD BE USED WHEN COORDINATES ARE PROVIDED FOR A PUBLIC LAND SURVEY CORNER AND SHALL INCLUDE ALL OF THE FOLLOWING ELEMENTS (A-D)

(A) IDENTIFY THE CORNER BY REFERENCE TO THE U.S. PUBLIC LAND SURVEY SYSTEM IN DIAGRAM AT RIGHT

■ = CORNER MONUMENT

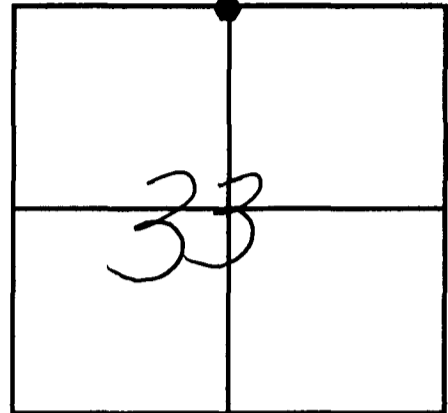

(B) COORDINATES:

GEOGRAPHIC (Degrees Minutes Seconds):

LATITUDE: none determined

LONGITUDE: \_\_\_\_\_

ELLIPSOID HT (m): \_\_\_\_\_

HORIZONTAL DATUM: \_\_\_\_\_

ORTHOMETRIC HT (U.S. ft): \_\_\_\_\_

VERTICAL DATUM: \_\_\_\_\_

traversed into corner from GPS control (6 set-ups with short 14 N, R 1 ~~EMX~~ back sites)  
 Coord. Quality (+/-)

VERNON COUNTY (U.S. FEET)

NORTHING (Y): 185,024.959 .10

EASTING (X): 836,118.100 .10

GPS METHOD USED TO COMPUTE COORDINATES (check as applicable):

RTK  single observation  averaged observations  
 Static Baseline  single baseline  averaged baselines .03' OPUS Solution

BASE CONTROL USED FOR COORDINATE COMPUTATION:

Station Name	Station Coordinates (Lat/Long)
<u>Greenwood N GPS</u>	<u>43 38 28.59107 090 21 27.35009</u>
<u>Dilly GPS</u>	<u>43 38 46.62992 090 27 05.22154</u>

\* Please List Additional Control Stations Used on Back of Form

Was a Least Squares Adjustment Used to Compute Coordinate? ~~YES~~/ No

Date(s) of GPS Observations: 00 / 00 / 0000

(C) REASON FOR COORDINATE SUBMITTAL (check one):

- Being Filed With a New U.S. PLS Monument Record  
 To Correct the Coordinates Listed on a Previously Filed PLS Monument Record  
 To Provide Coordinates for a Previously Filed PLS Monument Record without Coordinates  
 To Provide Supplemental Coordinates for a Previously Filed PLS Monument Record

MOST RECENT PLS MONUMENT RECORD DATE: 03 / 16 / 2006

R.L.S. WHO CREATED MOST RECENT PLS MONUMENT RECORD: Patrick A Carroll

(D) AGENT(S) PERFORMING GPS OBSERVATIONS & COORDINATE COMPUTATION

1) Josh Murphy

2) Richard Blakeslee

I, Richard Blakeslee

CERTIFY THAT THE COORDINATES PROVIDED ON THIS RECORD WERE DETERMINED BY ME OR UNDER MY DIRECTION AND CONTROL AND THAT THIS COORDINATE SUBMISSION FORM IS CORRECT AND COMPLETE TO THE BEST OF MY KNOWLEDGE AND BELIEF.

Richard T. Blakeslee 7-21-08  
 SIGNATURE DATE

Seal

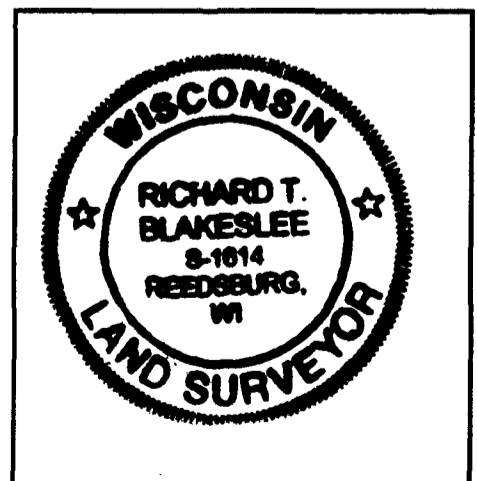

\* Please Provide Any Additional Notes/Information on Back of Form

# VERNON

## COUNTY

### Survey Monument Record

TYPE OF MONUMENT: 1/4" OD x 24" IRON PIPE SET

STATE PLANE COORDINATES: N \_\_\_\_\_

E \_\_\_\_\_

ELEVATION — M.S.L. DATUM: \_\_\_\_\_

THETA ANGLE: \_\_\_\_\_

FIELD BOOK: \_\_\_\_\_ PAGE \_\_\_\_\_

CORNER NO. \_\_\_\_\_

SECTION 33

TOWN T14N

RANGE R1E

HILLSBORO

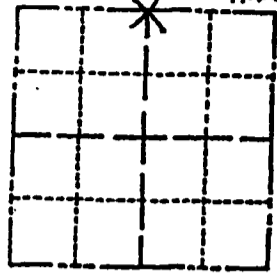

LOCATION  
(Indicated by 'X')

SEAL:



### BASIS FOR MONUMENT LOCATION

(Use reverse side if necessary)

Show info such as: History of corner, with reference to Vol. and pg. dates, surveyor; exact description of monument replaced; if location computed, by taped or EDM traverse; landowner remarks, etc.

My N $\frac{1}{4}$  corner location was determined by intersecting the NW section corner to the NE section corner and S $\frac{1}{4}$  corner up through Chafer's unrecorded, NOT TIED pipe. My N $\frac{1}{4}$  corner location is also a good "fit" for the N-S fence. My distance from my N $\frac{1}{4}$  corner to the center of section is 2617.39 feet. Chafer's pipe to the center of section is 2557.71 feet.

CERTIFIED CORRECT:

*Patrick A. Carroll*

Registered Land Surveyor

DATE: 3/16/06

### TIE SKETCH

(Show at least four ties)

TIES ARE 6" SPIKES

