

JUL 30 1993

GOVERNMENT CORNER RECORD

N 1/4 CORNER, SECTION 11, TOWNSHIP 14 NORTH, RANGE 1 EAST - ~~WEST~~

TOWN, CITY OR VILLAGE OF Hillsboro

TYPE OF MONUMENT: 2" Iron Pipe

ELEVATION - M.S.L. DATUM

WITNESSES TO CORNER LOCATION

Sean M. Walsh

Jason D. Dobbs

SECTION 11, T 14 N, R 1 E

TOWN OF Hillsboro

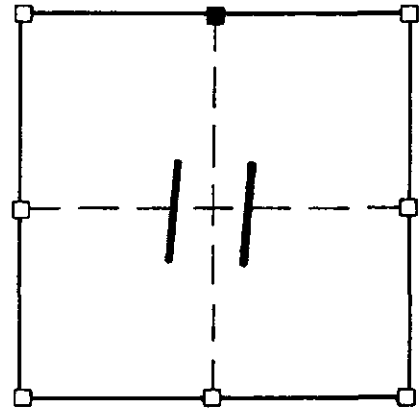

TIE SKETCH (SHOW ALL HELPFUL FEATURES)

o - 3/4" iron rod set

PASTURE

PASTURE

PASTURE

FIELDS

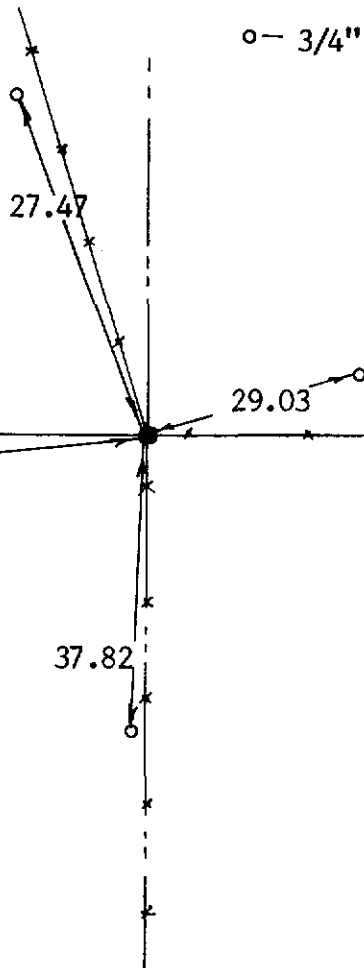

SURVEYOR'S CERTIFICATE

SEAL S. 2016

I, Sean M. Walsh, DO HEREBY CERTIFY THAT I have re-established the above corner at the location of physical occupation as it provided the best available evidence. This information is true and correct to the best of my information, knowledge and belief.



DATED THIS 10 DAY OF JUNE 19 93

REGISTERED LAND SURVEYOR

33

