

COUNTRY U. S. A.	TYPE OF MARK 2" IRON PIPE WITH BRASS CAP	STATION 1/4 CORNER 9/10	T. 13 N. R. 2 W.
LOCALITY LA FARGE, WIS.	STAMPING ON MARK 9/10	AGENCY (CAST IN MARKS) CORPS OF ENGRS	ELEVATION (FT) (M)
LATITUDE	LONGITUDE	DATUM	DATUM
(NORTHING)(EASTING) (FT) 590,084.07 (M)	(EASTING)(NORTHING) (FT) 1,338,020.37 (M)	GRID AND ZONE WIS. (SOUTH)	ESTABLISHED BY (AGENCY) CHICAGO DISTRICT
(NORTHING)(EASTING) (FT) (M)	(EASTING)(NORTHING) (FT) (M)	GRID AND ZONE	DATE 1965

TO OBTAIN GRID AZIMUTH, ADD TO THE GEODETIC AZIMUTH-  
TO OBTAIN GRID AZ. (ADD)(SUB.) TO THE GEODETIC AZIMUTH-

OBJECT	AZIMUTH OR DIRECTION (GEODETIC)(GRID) (MAGNETIC)	BACK AZIMUTH	GEOD. DISTANCE (METERS) (FEET)	GRID DISTANCE (METERS) (FEET)
RATTLESNAKE	N. 31°-42'-08" W			6623.80
REF. No. 1	S. 87°-36'-52" W			29.24
REF. No. 2	N. 51°-05'-52" E			43.07
REF. No. 3	N. 73°-26'-52" E			19.57

REFERENCE DISTANCES ARE HORIZONTAL & TO NAILS IN THE TREES. TREES ARE BLAZED & SCRIBED  $\overline{E}$ . USE TRAV. STA. RATTLESNAKE FOR A BACKSIGHT.

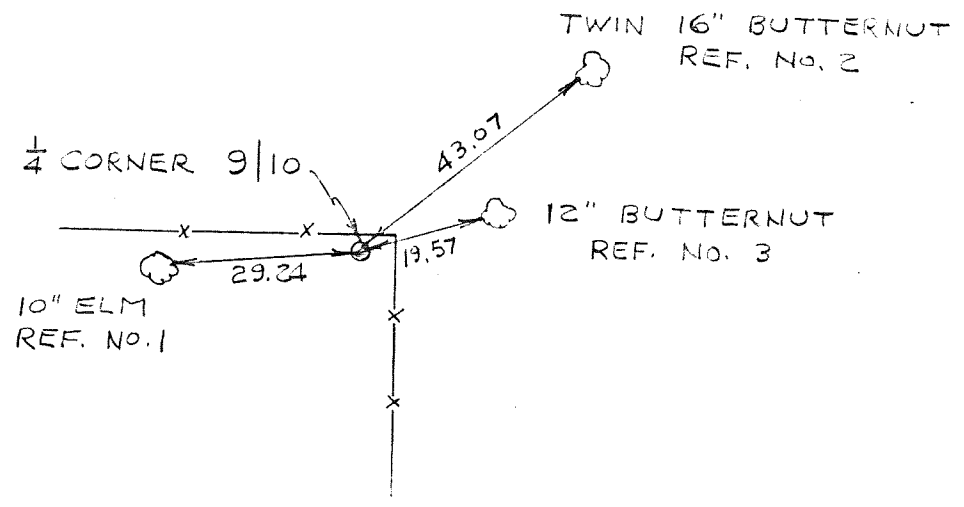

SKETCH