

Township N.° 13 N., Range N.° 7 West, 4<sup>th</sup> Mer.

Rec<sup>d</sup> with Sur<sup>g</sup> Gen<sup>l</sup> letter 26th May 1846

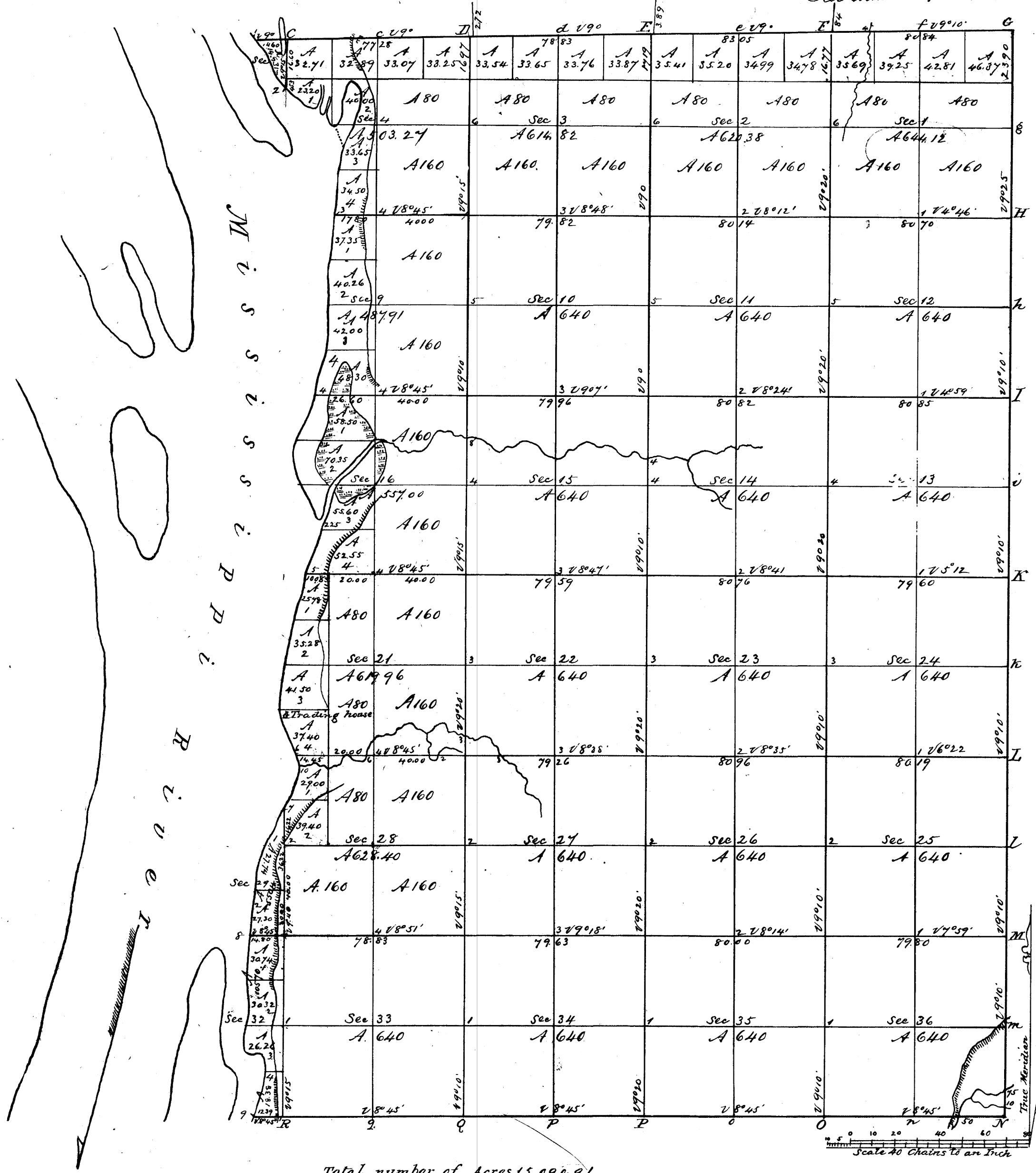

Total number of Acres 15,090.91

Surveys Designated	By Whom Surveyed	Date of Contract	Amount of Surveys M. Ch. Lk.	When Surveyed	When charged in the Sur <sup>g</sup> Gen <sup>l</sup> acc <sup>t</sup>
Township lines	J. E. Whiteaker	November 2 1844	14. 30. 89	November 1844	
Subdivisions	N. C. Whiteide	May 18, 1846 { Date of Bond }	45. 66. 65	November 1845	

The above Map of Township N.° 13 North of Range N.° 7 West 4<sup>th</sup> Principal Meridian Wisconsin Territory is strictly conformable to the field notes of the survey thereof on file in this Office, which have been examined and approved  
 Surveyor General's Office } Geo. V. Jones Sur. Gen.  
 Dubuque, May 26. 1846 }