

Township N.°12 N., Range N.° 7 West, 4th Mer.

Rec'd with N. G. letter of 26 May 1846

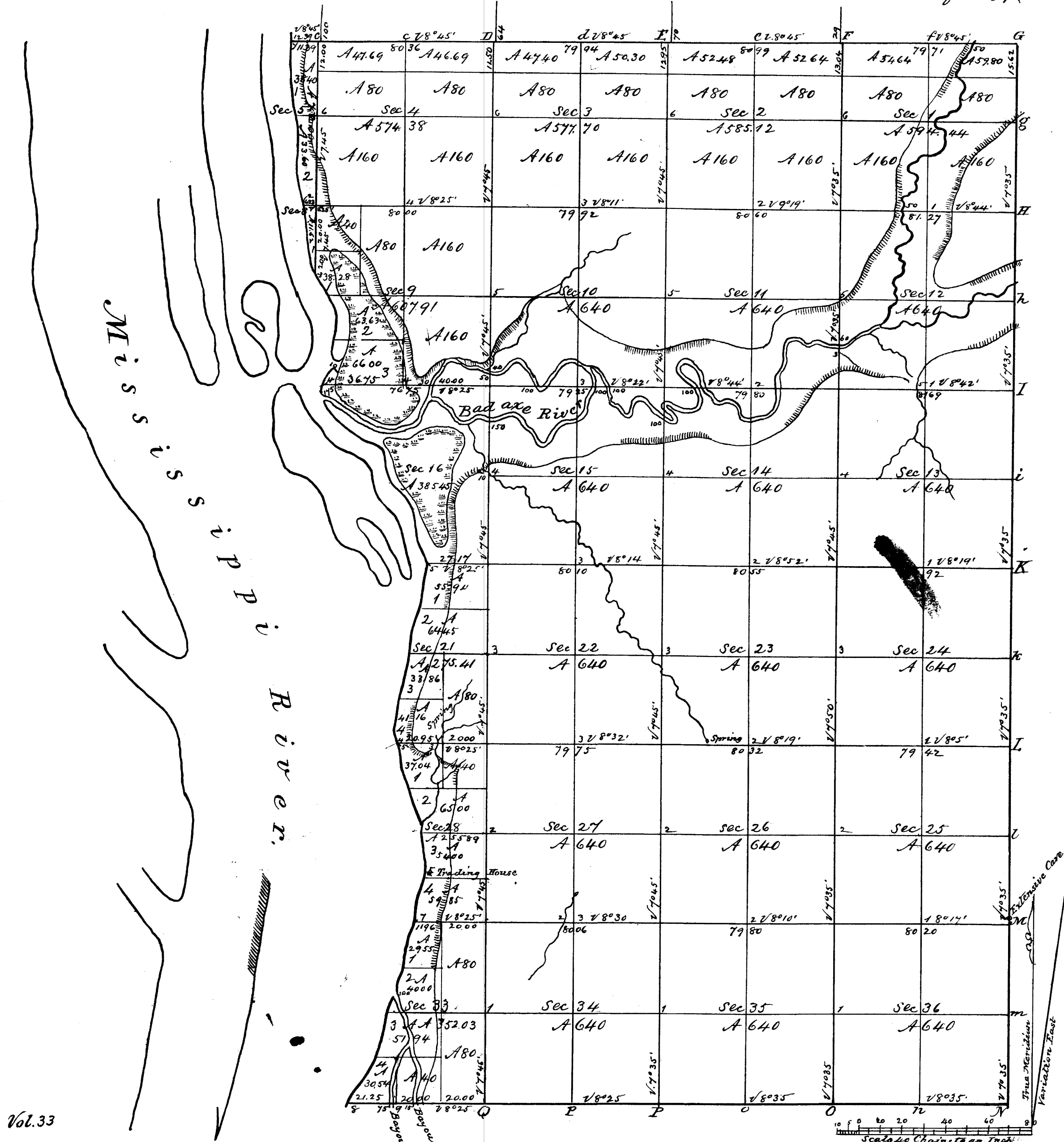

Vol. 33

Total number of Acres 13,891.55

Surveys Designated	By Whom Surveyed	Date of Contract	Amount of Surveys M. Ch. Ix.	When Surveyed	When Charged in the Sur. Cont. acc ^t
S. Township lines	Wm A. Burt	October 24, 1839	3 61.25	January 1840	1 st Q. 1841
E. & N. Township lines	J. E. Whiteaker	November 2, 1844	10. 08. 01	November 1844	
Subdivisions.	N. E. Whiteaker	{ May 18, 1846 { Date of Bond	43. 46. 90	October 1845	

The above Map of Township N.°12 North of Range N.°7 West 4th Principal Meridian, Wisconsin Territory, is strictly conformable to the field notes of the survey thereof on file in this Office, which have been examined and approved
 Surveyor General's Office *Sierra Jones* Sur. Genl.