

Township N<sup>o</sup> 11 N, Range N<sup>o</sup> 7 West 4<sup>th</sup> Mer.

Rec<sup>d</sup> with Sur<sup>or</sup> Gen's letter of Mar 22, 1844

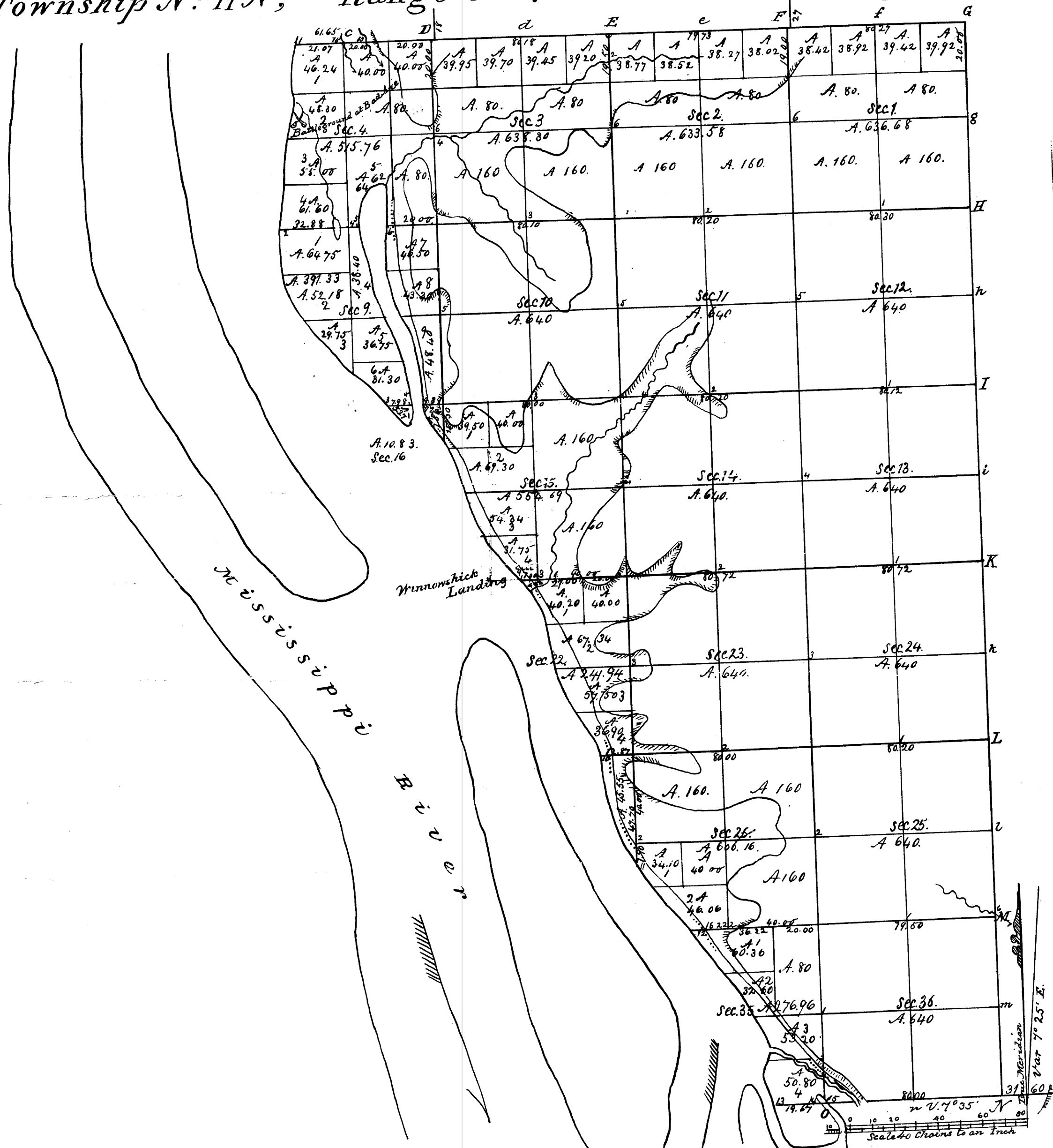

PLAINTIFF'S EXHIBIT 9  
 DEFENDANT'S EXHIBIT  
 JUL 7 1959  
 GERALD M. BRILLOWSKI  
 CIRCUIT COURT REPORTER  
 26<sup>th</sup> JUDICIAL CIRCUIT  
 BARABOO, WIS.

Plaintiff's  
**EXHIBIT**

JUL 15, 1959  
 BY Lucille Ostrom  
 COUNTY COURT REPORTER

Vol 33-B

Total number of Acres 10,305.98

Surveys Designated	By Whom Surveyed	Date of Contract	Amount of Surveys	When Surveyed	When Made and checked by the Sur <sup>or</sup> Gen <sup>l</sup>
Township lines	Wm. A. Burt	Oct 24, 1839	N. Chs 11. 05. 05	1 <sup>st</sup> of 1840	1 <sup>st</sup> of 1841
Subdivisions	A. L. Haven	May 23, 1843	36. 14. 57	4 <sup>th</sup> of 1843	4 <sup>th</sup> of 1843

The above Map of Township N<sup>o</sup> 11 North of Range N<sup>o</sup> 7 West Principal Meridian Wisconsin Territory is strictly conformable to the field notes of the survey thereof on file in this Office, which have been examined and approved.  
 Surveyor General's Office  
 Dubuque, Dec 27, 1843  
 James Wilson  
 Sur<sup>or</sup> Gen<sup>l</sup>

A.C.